

EVOOQUE

BY THE SEA





Set in the Lifestyle Capital of the Coast



Evoque is a masterful architectural expression presenting an outstanding selection of 1, 2 and 3 bedroom apartments situated in a prime position in Mombasa's lifestyle capital, Nyali, enjoying uninterrupted ocean views, minutes from the City Mall and a short walk from the beach.

Evoque's architecture embodies the landscape of its beachside setting, with unique architectural curvature that emulates the movement of the tides along Nyali's sandy shores.







A Nod to the Seaside



With a nod to the seaside climate, the building is composed of hard-wearing and robust materials such as stone, concrete, timber and steel – each one selected for its ability to age gracefully while its refined interior palette sets a new benchmark in designer sophistication and modern artistry.





An Interior Composition Forever Connected to the Ocean



Inspired by the essence of the unique coastal landscape it inhabits, Evoque's interior design mimics the forms, colors and textures of the water's edge, where deep blue waves crash upon rippling sands and lush greenery sprawls across basalt rocks.



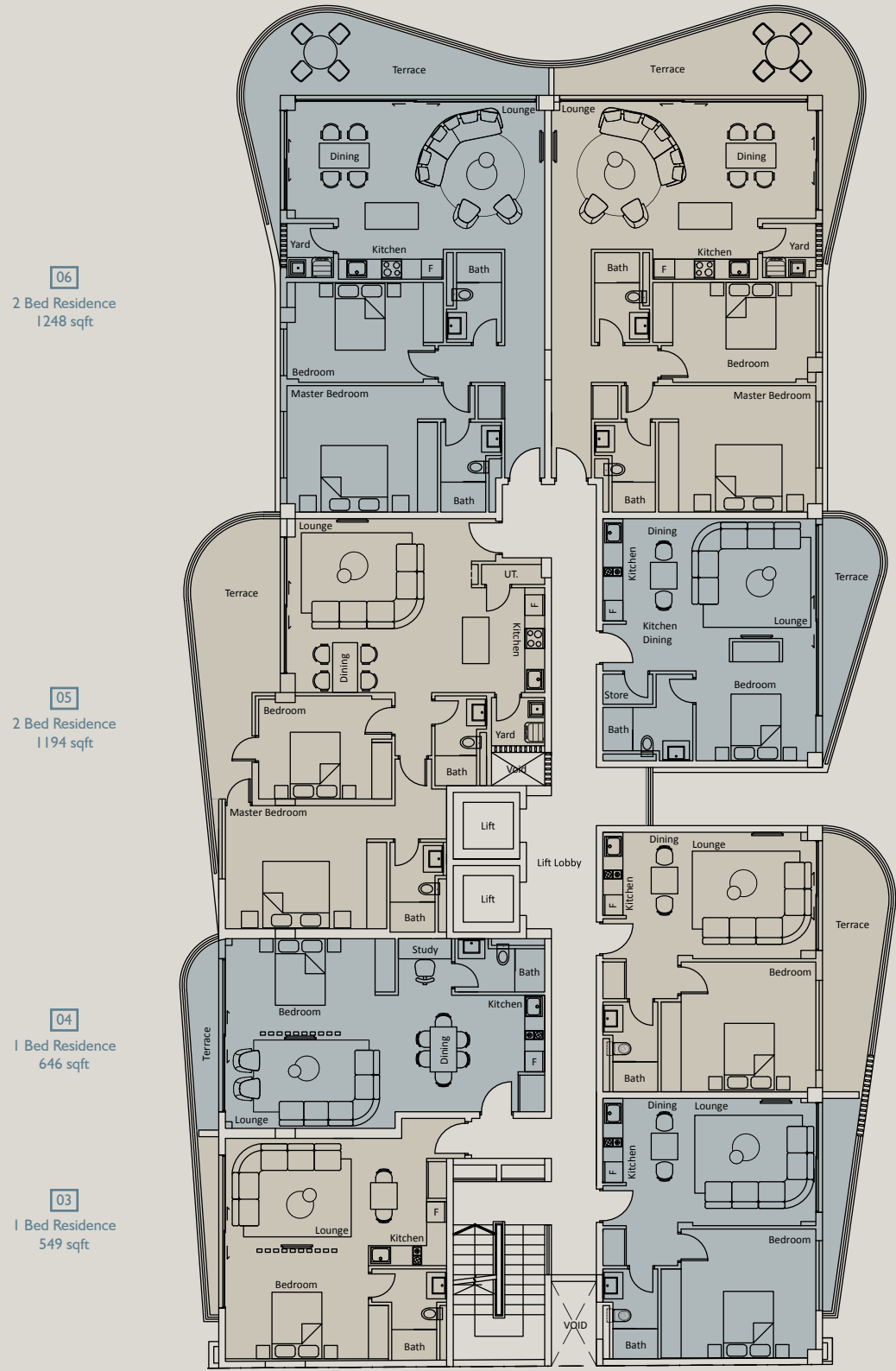

06
2 Bed Residence
1248 sqft

05
2 Bed Residence
1194 sqft

04
1 Bed Residence
646 sqft

03
1 Bed Residence
549 sqft

07
2 Bed Residence
1270 sqft

08
1 Bed Residence
602 sqft

01
1 Bed Residence
699 sqft

02
1 Bed Residence
613 sqft

RESIDENCE LAYOUTS
1ST - 6TH FLOOR

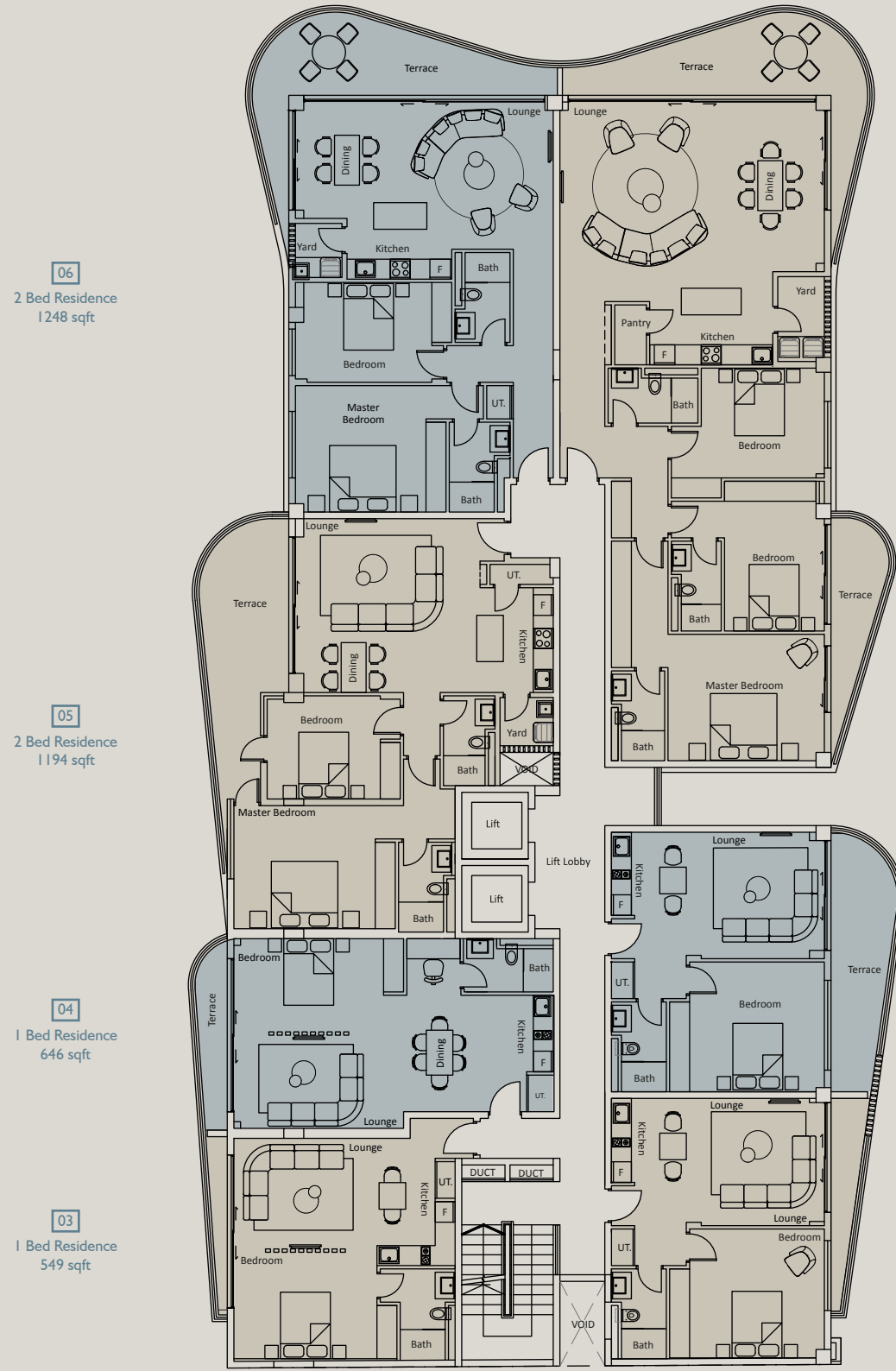

06
2 Bed Residence
1248 sqft

05
2 Bed Residence
1194 sqft

04
1 Bed Residence
646 sqft

03
1 Bed Residence
549 sqft

07
3 Bed Residence
1883 sqft

01
1 Bed Residence
699 sqft

02
1 Bed Residence
613 sqft

RESIDENCE LAYOUTS
7TH - 10TH FLOOR



Welcome to the Club



Evoque's rooftop club is dramatically set against a soaring backdrop of the ocean and sky, designed to provide amenities that embolden the luxurious seaside lifestyle.





An Emboldened Seaside Lifestyle



Residents will enjoy exclusive access to a spectacular infinity pool, poolside lounges, fitness studio and will be able to entertain outdoors in the stylish dining and BBQ area or watch movies in the outdoor residents cinema lounge.





All at the Waters Edge



Rooftop Amenities

- Infinity Swimming Pool
- Outdoor Residents Cinema Lounge
- BBQ, Dining & Chillout Area
- Poolside Lounge
- Sundowner Decks
- Fully Fitted Gym with Yoga Terrace

Evoque Inclusions

- Visitors' Reception
- Air-Conditioning Provision
- Borehole Water Supply
- Back-up Generator for all Apartments
- High Speed Lifts
- CCTV Surveillance
- Internet Connectivity
- SMATV
- Video Intercom
- Access Control
- Electric Fence
- Manned Security at Entrance



Coordinates
-4.010133,39.724648



An Investment Breeze

Locale

Located moments from the sand and overlooking endless ocean views, while within a minutes drive from Nyali's cosmopolitan lifestyle precincts, Evoque is connected to everything Nyali has to offer, yet enjoying the ambience of the soothing seaside atmosphere.

Growth Market

Nyali is undoubtedly the most burgeoning commercial hub of the coast, attracting large retail, commercial and residential interest both locally and internationally showing incredible potential for propulsion of capital growth and rental yields in the area.

Grade A Real Estate

With substantial participation within Nyali from an international audience, there is currently a missed opportunity in the provision of Grade A real estate that benchmarks global design standards and achieves rental returns that are worthy of the neighborhoods hospitality assets.

Unrivalled Amenities

With a shifting future global demographic that favors experiences, Evoque is intentionally designed for a heightened user experience with rooftop amenities currently unmatched in the area. This future-proofs Evoque, giving it long-term value creation and better month on month returns.

Short Let Returns

Nyali benefits from being both a commercial and a tourist hub - both of which create strong demand for short term rentals, effectively offering residential owners hospitality rate returns, which work to turbo boost their property value instantly.

The Evoque Team

Evoque is brought to you by a highly experienced team with a proven track record of delivering Kenya's most iconic residential projects.



Development Consultant
HassConsult Real Estate



Architect
Bowman Architects



Interior Designer
Lehem Interiors



Structural Engineers
Ngasi Consulting Engineers



Service Engineer
Gamma Delta

Developer
Nelita Development Limited

Sole and Exclusive Selling Agents



ABC Place Waiyaki Way
P.O. Box 14090 - 00800 Nairobi Kenya
T: 0709 479 000

E: hello@hassconsult.com | W: www.hassconsult.com
Sales: 0709 479 479

Property Reference No: 2303

